





## 28 White Avenue Romsey VIC

3  1  4 

Discover a comfortable and spacious 3-bedroom brick and tile home on a generous 1630 square metre block nestled in Romsey, in the picturesque Macedon Ranges.

This well-maintained family home offers practicality and functionality. The covered parking area accommodates up to 4 cars, providing convenient protection from the elements. Inside, a sizable rumpus room featuring a woodheater offers a versatile space for various activities, ensuring comfort year-round.

The modern kitchen adds to the appeal, combining both style and utility. It's an inviting space for culinary endeavours. The property's layout caters to a range of needs, whether you're seeking relaxation or room for gatherings. The main bedroom has direct access to the family bathroom which is shared by the other two

**Land Size** : 1630 sqm

**View** : <https://www.davidpinorealestate.com.au/sale/vic/greater-bendigo-region/romsey/residential/house/7721617>



**David Pino**  
0344101799



**Jamie Gramberg**  
0344101799

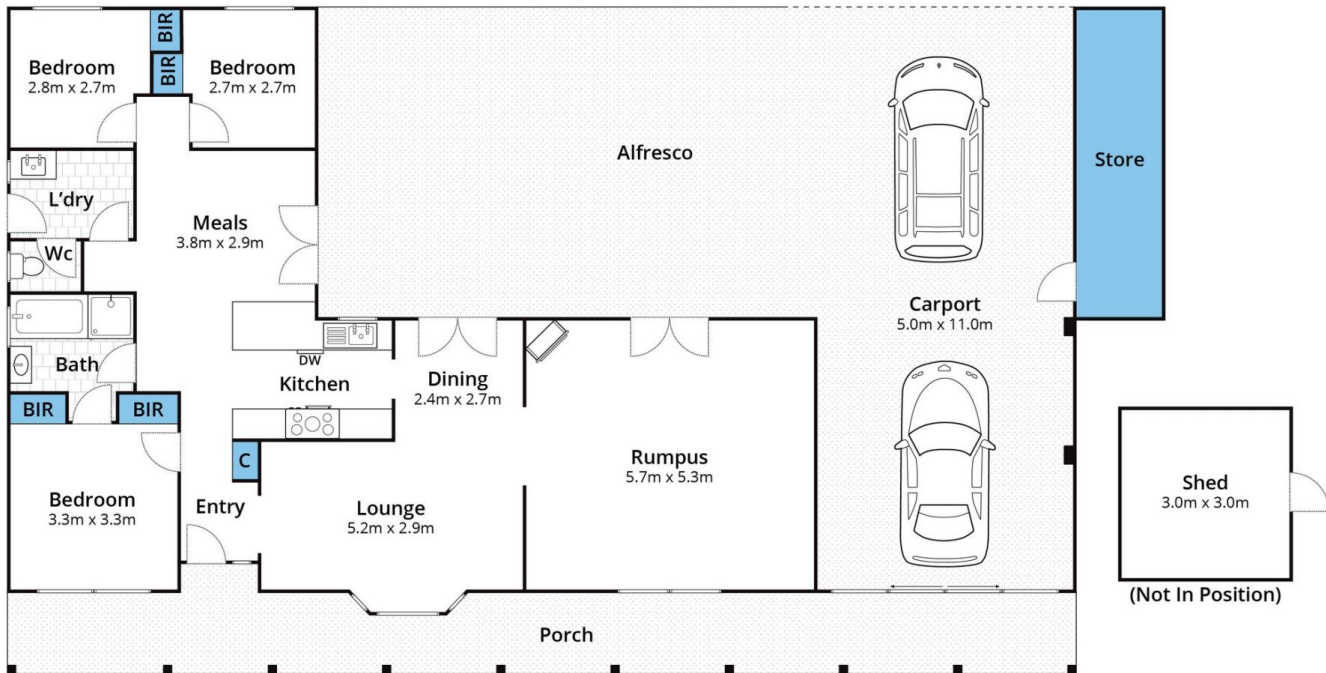

Approx House Area 137m<sup>2</sup>

Whilst [bwrn.com.au](http://bwrn.com.au) has made every attempt to ensure the accuracy of the floor plan contained here, measurements are approximate and no responsibility is taken for any error, omission, or mis-statement. This plan is for illustrative purposes only.

## 28 White Avenue, Romsey