



30 Bolithos Road Riddells Creek VIC

3 2 1

Discover the essence of country living in this charming cottage in Riddells Creek. With a northerly aspect and situated on a 695m² (approx.) block, this residence is a one-of-a-kind gem.

The traditional facade with its intricate fretwork, elegant finials, a welcoming veranda, canopy window awnings, and a picturesque roof pitch, gives this home instant appeal.

Step inside to find a thoughtfully designed floor plan encompassing three bedrooms, including a spacious main with a walk-in robe, built-in robes in the other bedrooms, two bathrooms, a generously sized laundry offering ample storage, and a sprawling open-plan kitchen, meals, and living area. Additionally, a single garage with remote access complements the practical layout.

Price : \$830,000 to \$880,000

Land Size : 695 sqm

View : <https://www.davidpinorealestate.com.au/sale/vic/macedon-ranges/riddells-creek/residential/house/7867912>



David Pino
0344101799



Jamie Gramberg
0344101799

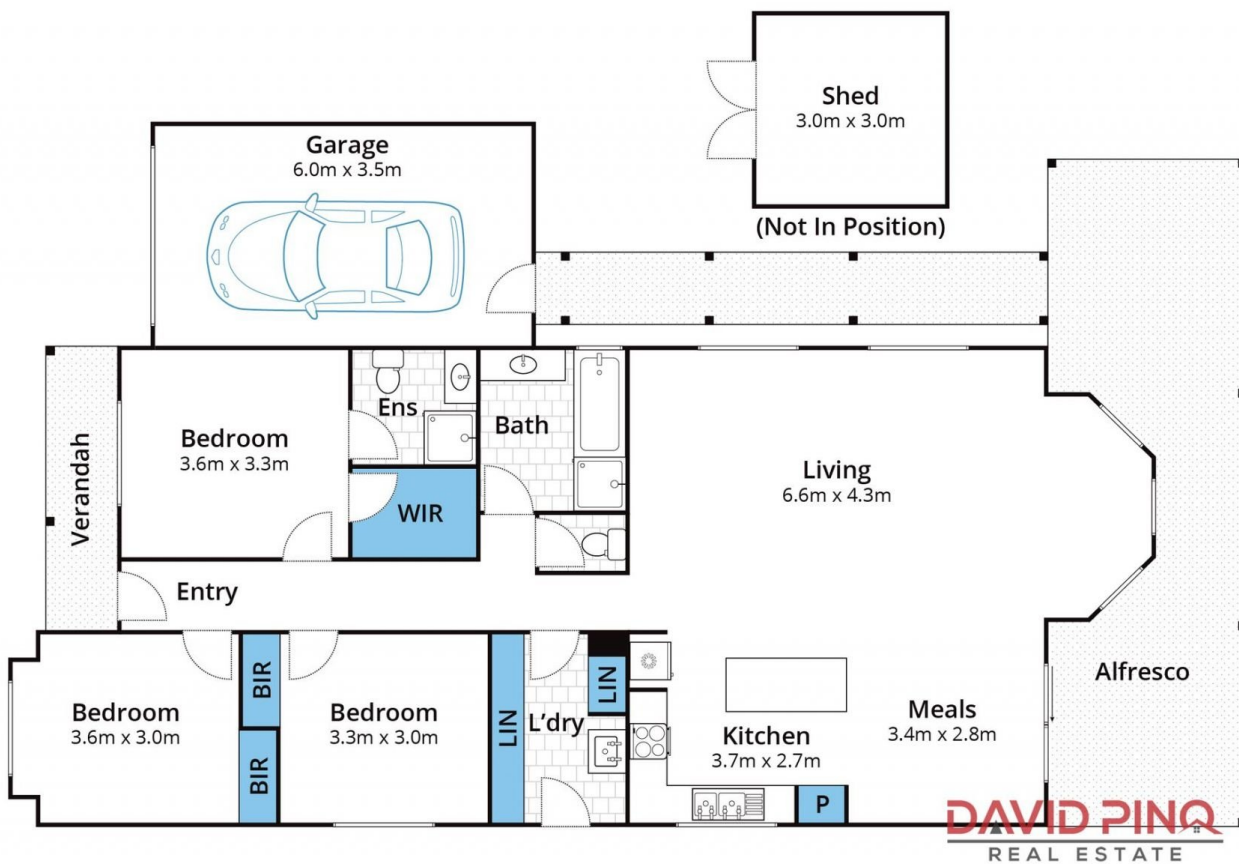

Approx House Area 142m²

Whilst bwr.com.au has made every attempt to ensure the accuracy of the floor plan contained here, measurements are approximate and no responsibility is taken for any error, omission, or mis-statement. This plan is for illustrative purposes only.

30 Bolithos Road, Riddells Creek