



114 Mt Gisborne Road Gisborne VIC

3 3 4

Imagine owning 29 acres of land close to Gisborne with sweeping views of Mt. Macedon and the Ranges. Not only do you get a solid three-bedroom, three-bathroom home, but there are also endless possibilities for development.

Inside, there are three large, carpeted bedrooms, each with floor-to-ceiling built-in robes, and access to the outdoors. The main bedroom has a split system for climate control, and generous walk-in robes for ample storage. The ensuite includes a spacious shower, skylight, heated towel rail, and a convenient built-in shaving cabinet. The family bathroom is centrally situated with a toilet, shower, bath and single vanity.

The dark slate tiles on the floors complement the timbered walls and high ceilings, and skylights dotted throughout flood the home with light.

Price : \$2,800,000
Land Size : 29 Acres
View : <https://www.davidpinorealestate.com.au/sale/vic/macedon-ranges/gisborne/residential/home/7922340>



David Pino
0344101799



Jamie Gramberg
0344101799

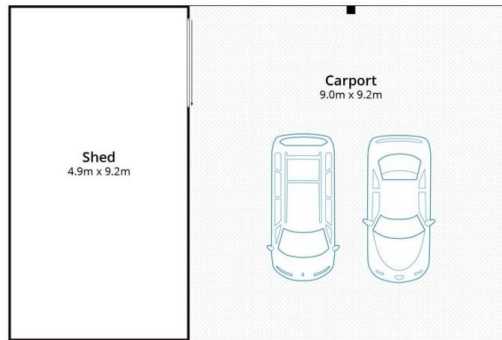
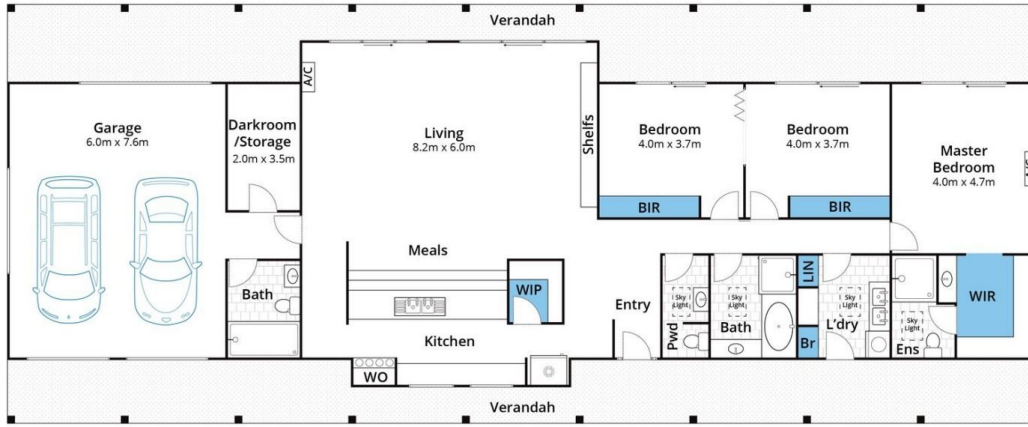

Approx House Area 233m²

Whilst bwrn.com.au has made every attempt to ensure the accuracy of the floor plan contained here, measurements are approximate and no responsibility is taken for any error, omission, or mis-statement. This plan is for illustrative purposes only.

114 Mount Gisborne Road, Gisborne