



28 White Avenue Romsey VIC

3 1 4

Discover a comfortable and spacious 3-bedroom brick and tile home in the picturesque Macedon Ranges.

This well-maintained family home offers practicality and functionality. The covered parking area accommodates up to 4 cars, providing convenient protection from the elements. Inside, a sizable rumpus room featuring a woodheater offers a versatile space for various activities, ensuring comfort year-round.

The modern kitchen adds to the appeal, combining both style and utility. It's an inviting space for culinary endeavours. The property's layout caters to a range of needs, whether you're seeking relaxation or room for gatherings. The main bedroom has direct access to the family bathroom which is shared by the other two bedrooms. French doors open to a huge indoor/outdoor

View : <https://www.davidpinorealestate.com.au/lease/vic/greater-bendigo-region/romsey/residential/house/7964892>



David Pino
0344101799



Rebecca Pino
0344101799

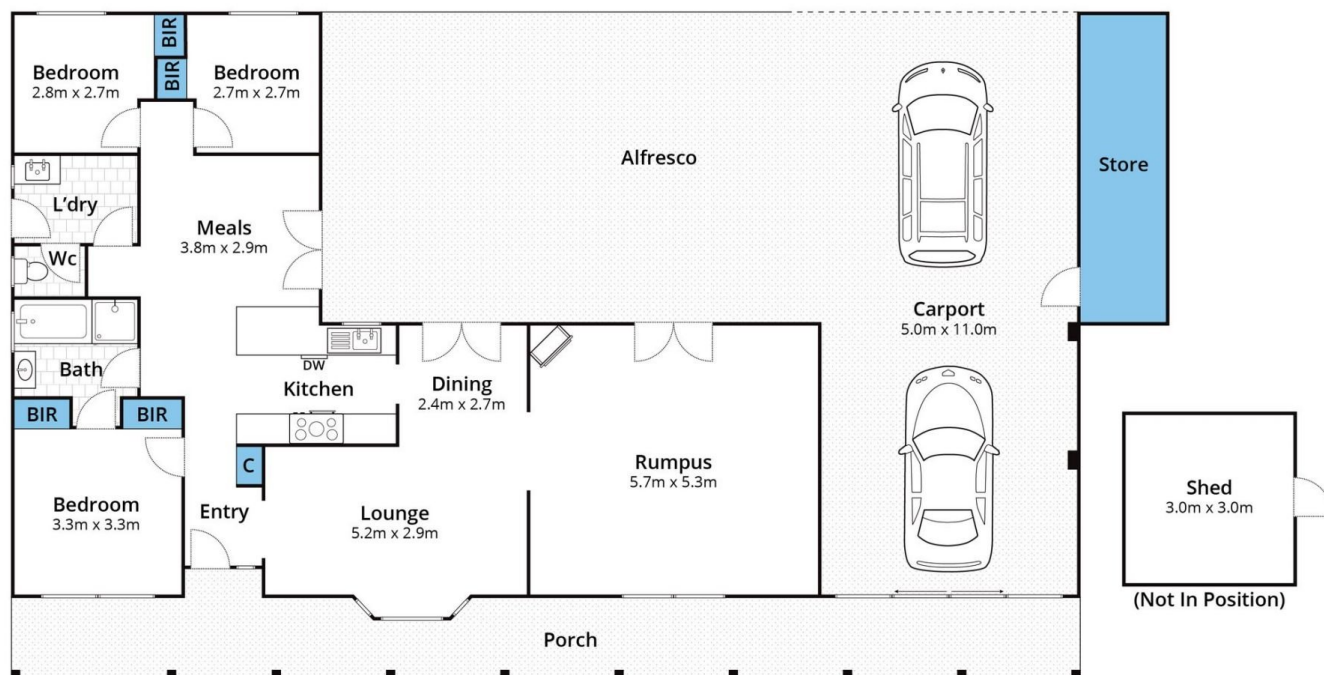

DAVID PINQ
REAL ESTATE

Approx House Area 137m²

Whilst bwrm.com.au has made every attempt to ensure the accuracy of the floor plan contained here, measurements are approximate and no responsibility is taken for any error, omission, or mis-statement. This plan is for illustrative purposes only.

28 White Avenue, Romsey