



1/39 Somerville Lane Riddells Creek VIC

2 1 1

Discover this beautifully presented front unit in the heart of Riddells Creek, offering both comfort and convenience. Situated just a 3-minute drive to the Riddells Creek Train Station and the town center, all your essentials are within easy reach.

Step inside to find a neat and tidy interior, perfect for easy living. The home features 2 spacious bedrooms and a well-maintained bathroom, making it ideal for a range of buyers. The open-plan layout is complemented by a split system and a wall furnace, ensuring year-round comfort.

The unit boasts excellent street appeal with a lovely front garden that greets you as you arrive. The remote-controlled single-car garage provides effortless parking and storage.

[For full version visit the website](https://www.davidpinorealestate.com.au/sale/vic/macedon-ranges/riddells-creek/residential/unit/8139721)

Type : Unit
Price : \$ 520,000
Land Size : 269.9 sqm
View : <https://www.davidpinorealestate.com.au/sale/vic/macedon-ranges/riddells-creek/residential/unit/8139721>



Jamie Gramberg
0344101799



David Pino
0344101799

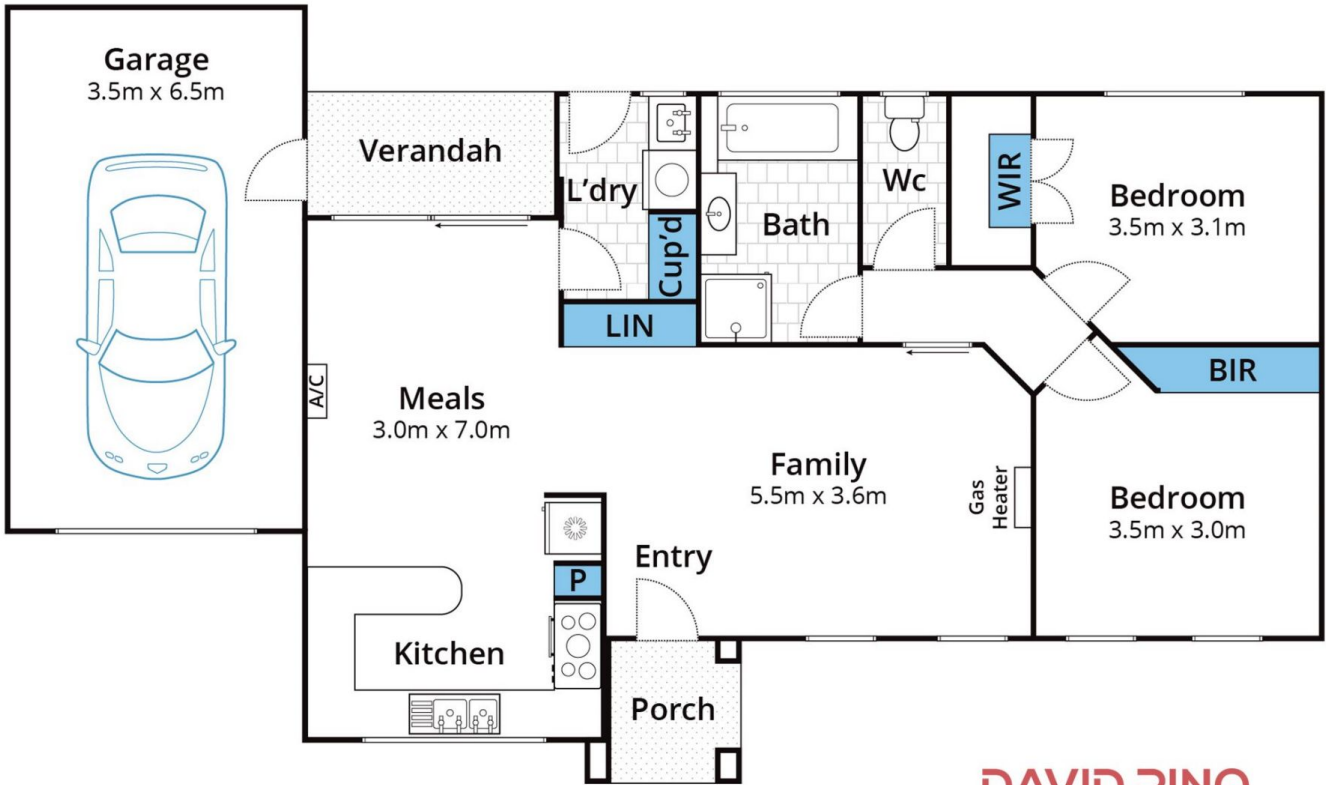

Approx. Area 112m²

Whilst bwrn.com.au has made every attempt to ensure the accuracy of the floor plan contained here, measurements are approximate and no responsibility is taken for any error, omission, or mis-statement. This plan is for illustrative purposes only.

1/39 Somerville Lane, Riddells Creek