



## 11 Bradman Drive Sunbury VIC

4 2 2

Situated on a generous 805m<sup>2</sup> block in the sought-after Ashfield Estate, this stunning 4-bedroom, 2-bathroom family home with an additional powder room is perfect for growing families.

With high ceilings and three living spaces, there's plenty of room to relax, entertain, or unwind.

The kitchen is well-appointed and spacious, offering ample storage and bench space, making meal preparation a breeze for busy families.

The large alfresco area is perfect for hosting gatherings, offering seamless indoor-outdoor living.

Stay comfortable year-round with ducted heating and evaporative cooling, and enjoy the energy savings of a 5kW solar system.

The home also features a 2-car garage, providing ample

**Type** : House  
**Price** : \$820,000 to \$860,000  
**Land Size** : 805 sqm  
**View** : <https://www.davidpinorealestate.com.au/sale/vic/macedon-ranges/sunbury/residential/house/8155969>



**Jamie Gramberg**  
0344101799



**David Pino**  
0344101799

[For full version visit the website](https://www.davidpinorealestate.com.au)

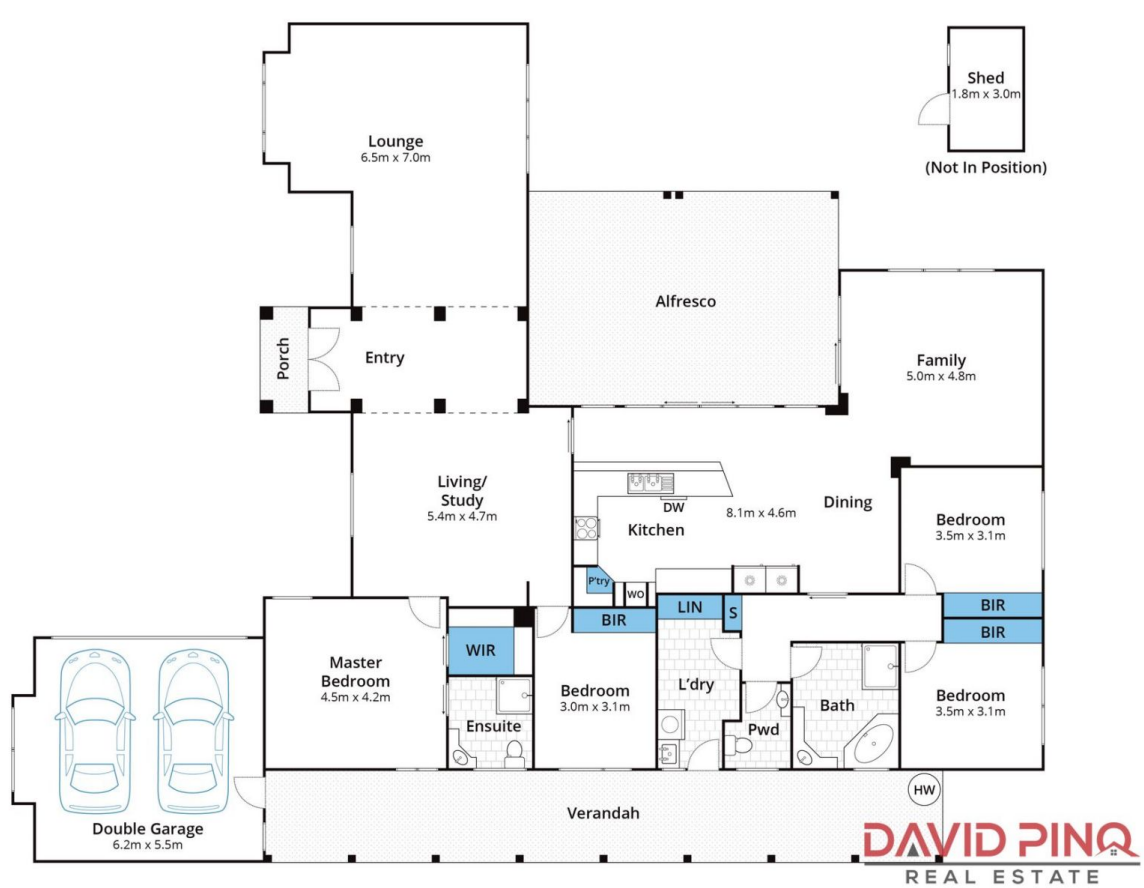

Approx House Area 268m<sup>2</sup>

Whilst [bwr.com.au](http://bwr.com.au) has made every attempt to ensure the accuracy of the floor plan contained here, measurements are approximate and no responsibility is taken for any error, omission, or mis-statement. This plan is for illustrative purposes only.

## 11 Bradman Drive, Sunbury