



149 Yaamba Drive Riddells Creek VIC

4 2 4

This beautifully designed home features spotted gum flooring throughout, complementing its sleek and modern aesthetic. Large, double-glazed windows fill every room with natural light while ensuring energy efficiency, assisted by LED downlights throughout the property.

The master suite offers a peaceful retreat, complete with plush carpet, blinds, and his-and-her walk-in robes with custom cabinetry. The ensuite is a private oasis, boasting a double vanity, double shower, and elegant floor-to-ceiling tiling.

Culinary enthusiasts will fall in love with the heart of the home - a stylish kitchen featuring a 40mm stone benchtop, breakfast bar, and premium Neff appliances, including a dishwasher, double oven, cooktop, and plenty of storage

[For full version visit the website](https://www.davidpinorealestate.com.au/sale/vic/macedon-ranges/riddells-creek/residential/house/8162887)

Type : House
Price : \$2,400,000 to \$2,500,000
Land Size : 7.77 ha
View : <https://www.davidpinorealestate.com.au/sale/vic/macedon-ranges/riddells-creek/residential/house/8162887>



David Pino
0344101799



Jamie Gramberg
0344101799

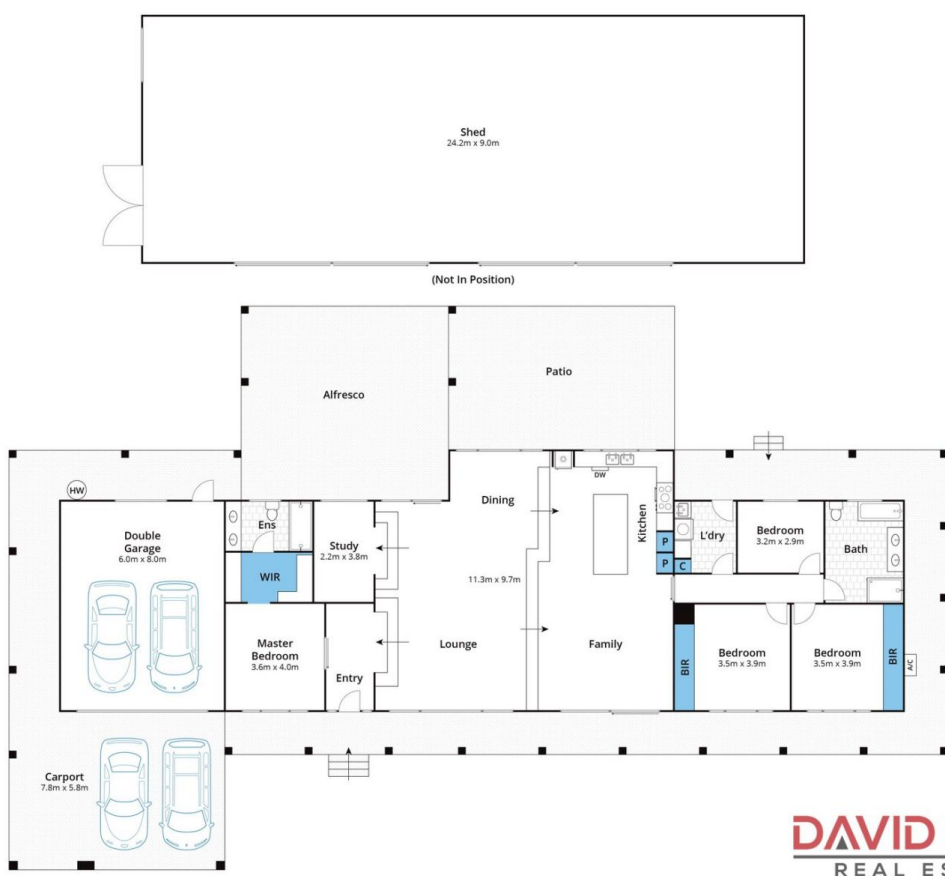

Approx. Area 253m²
Whilst bwrn.com.au has made every attempt to ensure the accuracy of the floor plan contained here, measurements are approximate and no responsibility is taken for any error, omission, or mis-statement. This plan is for illustrative purposes only.

149 Yaamba Drive, Riddells Creek